

ipso 032

Rückschlagverbinder
Straight unidirectional connection
Valvola di non ritorno

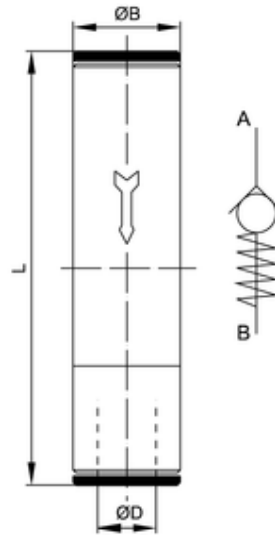
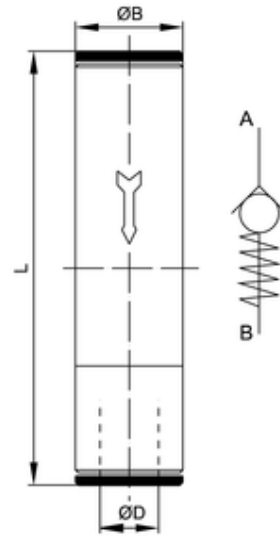

| ITV | ØD | ØB | L |
|--------|----|----|----|
| 203203 | 6 | 11 | 50 |

| | |
|--|--------------------------|
| Körper: | CW614N vernickelt |
| Body: | CW614N nickel-plated |
| Corpo: | ottone CW 614N nichelato |
| O-Ring: | NBR |
| O-Rings: | NBR |
| O-Ring: | NBR 70 SH |
| Betriebstemperatur: | -20°C bis +80°C |
| Working temperature: | -20°C up to +80°C |
| Temperatura di utilizzo: | da -20°C a +80°C |
| Betriebsdruck: | 0,2 - 10 bar |
| Working pressure: | 0,2 - 10 bar |
| Pressione di utilizzo: | da 0,2 a 10 bar |
| für geölte und ungeölte Druckluft | |
| for lubricated and non-lubricated compressed air | |
| per aria compressa sia lubrificata che non | |