

ipso 032

Rückschlagverbinder
Straight unidirectional connection
Valvola di non ritorno

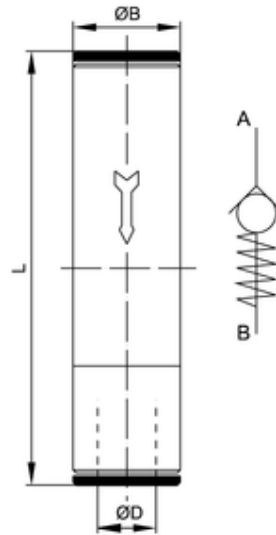
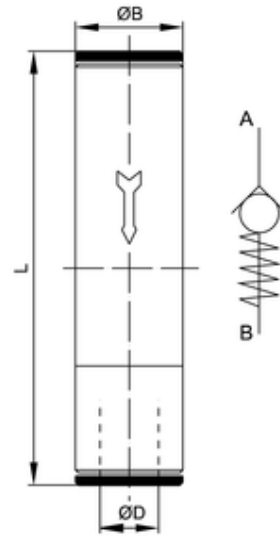

ITV	ØD	ØB	L
203204	8	13	53,5

Körper:	CW614N vernickelt
Body:	CW614N nickel-plated
Corpo:	ottone CW 614N nichelato
O-Ring:	NBR
O-Rings:	NBR
O-Ring:	NBR 70 SH
Betriebstemperatur:	-20°C bis +80°C
Working temperature:	-20°C up to +80°C
Temperatura di utilizzo:	da -20°C a +80°C
Betriebsdruck:	0,2 - 10 bar
Working pressure:	0,2 - 10 bar
Pressione di utilizzo:	da 0,2 a 10 bar
für geölte und ungeölte Druckluft	
for lubricated and non-lubricated compressed air	
per aria compressa sia lubrificata che non	