

**SC**Schalldämpfer  
Silencer

Material: Sinterbronze  
 Filterfeinheit: 50 $\mu$   
 Betriebsdruck: max. 10 bar  
 Betriebstemperatur: -10°C bis +150°C  
 zyl. Gewinde: DIN EN ISO 228  
 metr. Gewinde: DIN EN ISO 262

material: sintered bronze  
 filter mesh: 50 $\mu$   
 working pressure: max. 10 bar  
 working temperature: -10°C up to +150°C  
 cyl. threads: DIN EN ISO 228  
 metr. threads: DIN EN ISO 262

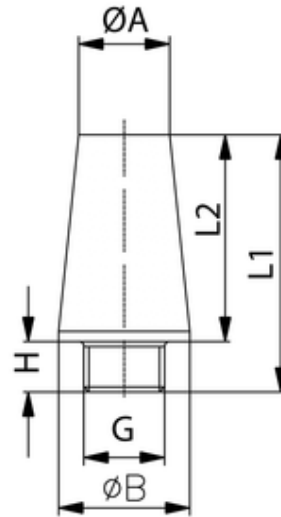

<i>ITV</i>	<i>G</i>	<i>ØB</i>	<i>H</i>	<i>L1</i>	<i>L2</i>	<i>ØA</i>
303019	G1/8 IG	12	6	23	15	8