

Präzisions-Druckminderer

Precision pressure regulator
Riduttore di precisione

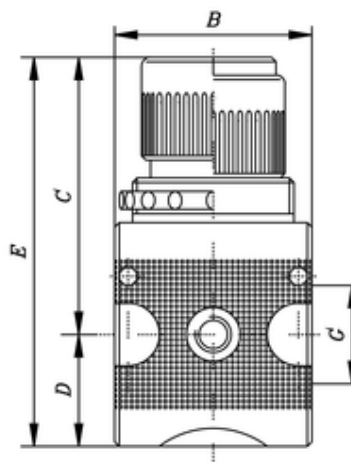

| ITV | G | NI/min | B | C | D | E |
|--------|------|--------|----|----|----|----|
| 120401 | G1/4 | 2.000 | 48 | 67 | 27 | 94 |

ohne Manometer
without manometer
senza manometro

| | |
|------------------------------|-------------------------|
| Manometeranschluss: | 1/4" |
| Pressure gauge thread: | 1/4" |
| Attacco manometro (filetto): | 1/4" |
| max. Betriebsdruck: | 16 bar |
| max. Inlet pressure: | 16 bar |
| Pressione max di esercizio: | 16 bar |
| max. Temperatur bei 10 bar: | +60 °C |
| max. temperature at 10 bar: | +60 °C |
| Temperatura max a 10 bar: | +60 °C |
| Einbauposition: | beliebig |
| Mounting position: | any position |
| Posizione di montaggio: | in qualsiasi posizione |
| Eigenluftverbrauch: | 2,6 l/min. |
| Own air use: | 2,6 l/min. |
| Consumo di aria propria: | 2,6 l/min. |
| Befestigung: | Winkel oder 2 Bohrungen |
| Fortify: | elbow or 2 drillings |
| Fissaggio: | staffa o 2 fori |