

Schalldämpfer mit Schlitz
Silencer with nut
Silenziatore a tronco di cono

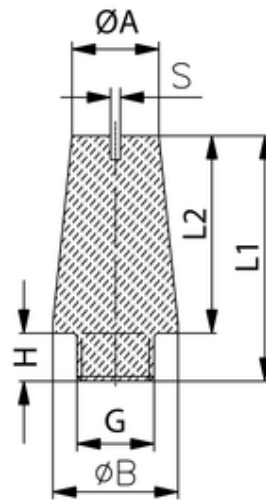

| ITV | G | ØB | H | L1 | L2 | ØA | S |
|--------|------|----|-----|----|------|----|-----|
| 303003 | G1/4 | 14 | 8,5 | 27 | 18,5 | 10 | 1,5 |

| | |
|---------------------------|-----------------------------|
| Material: | Sinterbronze |
| Material: | sintered bronze |
| Materiale: | bronzo sferico sinterizzato |
| Filterfeinheit | 50 µ |
| filter mesh: | 50 µ |
| Elemento filtrante: | 50 µ |
| Betriebsdruck: | max. 10 bar |
| Working pressure: | max. 10 bar |
| Pressione di esercizio: | max. 10 bar |
| Betriebstemperatur: | -10 °C bis +150 °C |
| Working temperature: | -10 °C up to +150 °C |
| Temperatura di esercizio: | da -10 °C a +150 °C |
| zyl. Gewinde: | DIN EN ISO 228-1 |
| cyl. threads: | DIN EN ISO 228-1 |
| Filettatura: | DIN EN ISO 228-1 |