

SFE

Schalldämpfer
Silencer

Material:
Körper: Sinterbronze & Messing
Filter: Edelstahl AISI 304L
Filterfeinheit: 70µ
Betriebsdruck: max. 10 bar
Betriebstemperatur: -20°C bis +150°C
zyl. Gewinde: DIN EN ISO 228
metr. Gewinde: DIN EN ISO 262

material:
body: sintered bronze & brass
filter: inox AISI 304L
filter mesh: 70µ
working pressure: max. 10 bar
working temperature: -20°C up to +150°C
cyl. threads: DIN EN ISO 228
metr. threads: DIN EN ISO 262

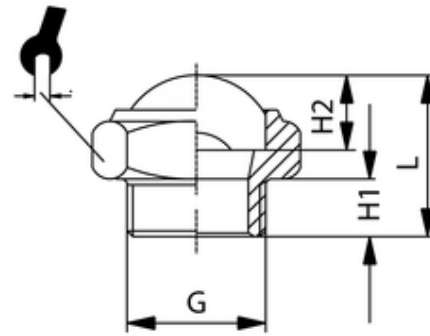

| <i>ITV</i> | <i>G</i> | <i>H1</i> | <i>H2</i> | <i>L</i> | <i>SW</i> |
|------------|----------|-----------|-----------|----------|-----------|
| 303103 | G1/4 | 8 | 4 | 19 | 16 |