

SR

Schalldämpfer
Silencer

Material:
Körper: Messing, vernickelt
Filter: Bronze
Betriebsdruck: max. 12 bar
Betriebstemperatur: 0°C bis +150°C

material:
body: brass, nickel-plated
filter: bronze
working pressure: max. 12 bar
working temperature: 0°C to +150°C

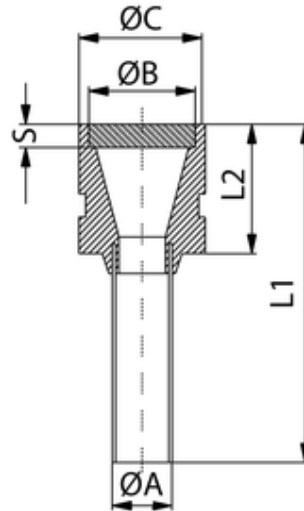

ITV	ØA	ØB	ØC	L1	L2	S
303186	12	10	14	53,5	15,5	4