

Drosselhohlschraube

mit Schlitzschraube

Screw for flow regulation with slotted screw

Vite di regolazione con regolazione a cacciavite

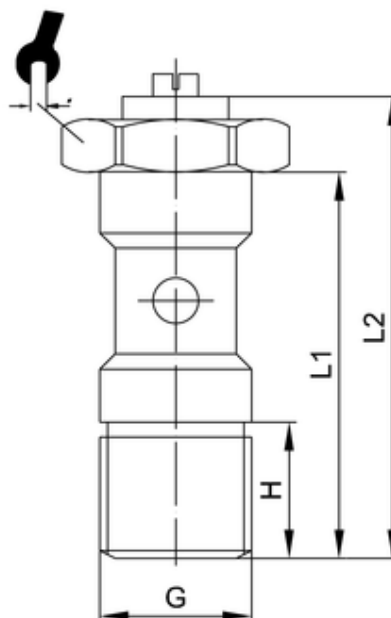

ITV	Typ	G	H	L1	L2	sw	NI/min*
304005	C	G1/8	6	23,5	32	14	310

Körper:	CW614N vernickelt
Body:	CW614N nickel-plated
Corpo:	ottone CW614N nichelato
O-Ring:	NBR
O-ring:	NBR
O-Ring:	NBR 70 SH
zyl. Gewinde:	DIN EN ISO 228
cyl. Threads:	DIN EN ISO 228
Filettatura:	gas cilindrica ISO 228
Betriebstemperatur:	-20 °C bis +80 °C
Working temperature:	-20 °C up to +80 °C
Temperatura di esercizio:	da -20 °C a +80 °C
Betriebsdruck:	max. 10 bar
Working pressure:	max. 10 bar
Pressione di esercizio:	max. 10 bar
Für geölte und ungeölte Druckluft.	
For lubricated and non-lubricated compressed air.	
Per aria compressa sia lubrificata che non.	

A = Zuluft / for valves / per valvola B = Abluft / for cylinders / per cilindro C = Beidseitig / bidirectional / bidirezionale