

# 1/3-Verschraubung

Hose connector 1/3

Portagomma maschio cilindrico

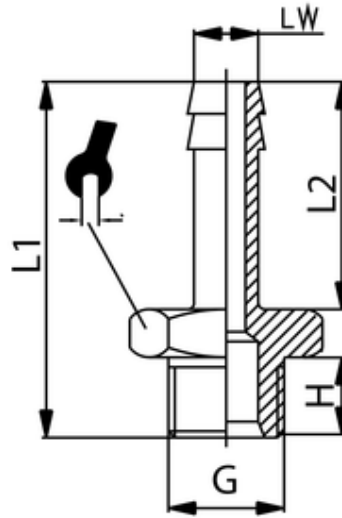

| ITV    | LW | G    | H | L2 | L1 | sw |
|--------|----|------|---|----|----|----|
| 401027 | 13 | G3/8 | 9 | 35 | 49 | 19 |

|                            |  |                   |
|----------------------------|--|-------------------|
| <b>Betriebstemperatur:</b> | max. 150°C                                     |                   |
| <b>Betriebsdruck:</b>      | bis 60bar                                      |                   |
| <b>Werkstoff:</b>          | Messing vernickelt/ blank                      | CW614N und CW617N |
| <b>Gewinde:</b>            | zyl. Gewinde DIN 3852<br>kon. Gewinde DIN 3858 |                   |
| <b>Medium:</b>             | Luft, Wasser, Öl, Dampf, etc.                  |                   |

|                               |   |  |
|-------------------------------|---|--|
| <b>Operating temperature:</b> | max. 150°C                                      |  |
| <b>Operating pressure:</b>    | up to 60bar                                     |  |
| <b>Material:</b>              | brass nickel-plated/ polished CW614N and CW617N |  |
| <b>Thread:</b>                | cyl. thread DIN 3852<br>con. thread DIN 3858    |  |
| <b>Medium:</b>                | Air, water, oil, steam, etc.                    |  |