

# T-Stück in Blockform

Vernickelt, 2× IG - 1× AG  
Blockshaped T - F. F. M.  
T a blocchetto F.F.M.

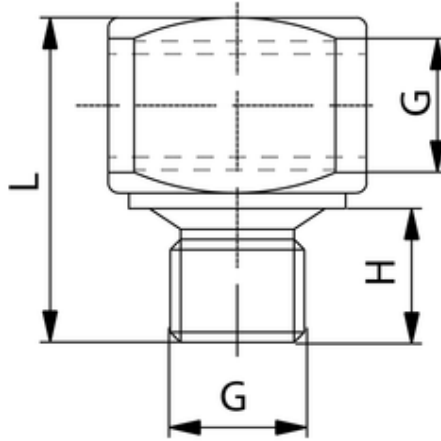

ITV	G	H	L
401922	G1/8	6,5	16,5

<b>Betriebstemperatur:</b>	max. 150°C		
<b>Betriebsdruck:</b>	bis 60bar		
<b>Werkstoff:</b>	Messing vernickelt/ blank	CW614N und CW617N	
<b>Gewinde:</b>	zyl. Gewinde DIN 3852 kon. Gewinde DIN 3858		
<b>Medium:</b>	Luft, Wasser, Öl, Dampf, etc.		

<b>Operating temperature:</b>	max. 150°C		
<b>Operating pressure:</b>	up to 60bar		
<b>Material:</b>	brass nickel-plated/ polished	CW614N and CW617N	
<b>Thread:</b>	cyl. thread DIN 3852 con. thread DIN 3858		
<b>Medium:</b>	Air, water, oil, steam, etc.		