

Stecknippel

mit Innengewinde
Female coupling
Innesto rapido femmina

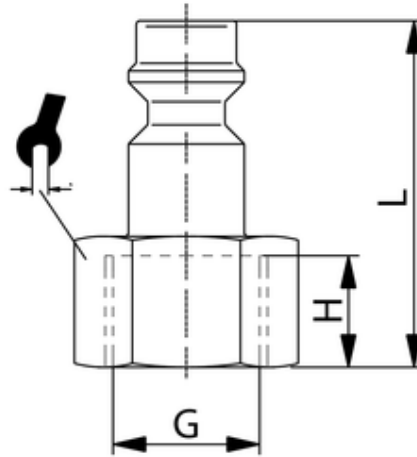

| ITV | DN | G | H | L | sw |
|--------|-----|------|----|----|----|
| 430044 | 7,2 | G3/8 | 10 | 33 | 19 |

| | |
|---------------------------|------------------------|
| Körper: | Messing |
| Body: | brass |
| Corpo: | ottone |
| Betriebstemperatur: | -20 °C bis +100 °C |
| Working temperature: | -20 °C to +100 °C |
| Temperatura di esercizio: | da -20 °C a +100 °C |
| Betriebsdruck: | max. 35 bar |
| Working pressure: | max. 35 bar |
| Pressione di esercizio: | max. 35 bar |
| Medium: | Druckluft, Wasser. |
| Medium: | compressed air, water. |
| Fluido: | Aria compressa, acqua. |
| zyl. Gewinde: | DIN EN ISO 228 |
| cyl. threads: | DIN EN ISO 228 |
| Filettatura: | DIN EN ISO 228 |