

Stecknippel vernickeltmit Innengewinde
Female coupling nickel plated

Material: Messing
 Betriebstemperatur: -20°C bis +100°C
 Betriebsdruck: max. 35 bar
 Medium: Druckluft, Wasser
 zyl. Gewinde: DIN EN ISO 228

material: brass
 working temperature: -20°C to +100°C
 working pressure: max. 35 bar
 medium: compressed air, water
 cyl. threads: DIN EN ISO 228

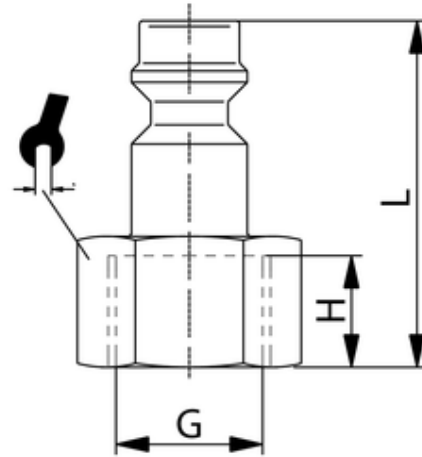

<i>ITV</i>	<i>DN</i>	<i>G</i>	<i>H</i>	<i>L</i>	<i>SW</i>
430045-VN	7,2	G1/2	12	36	24