

Stecknippel vernickelt

für Kunststoffschlauch
Coupling for plastic hose nickel plated
Innesto rapido per tubo in plastica

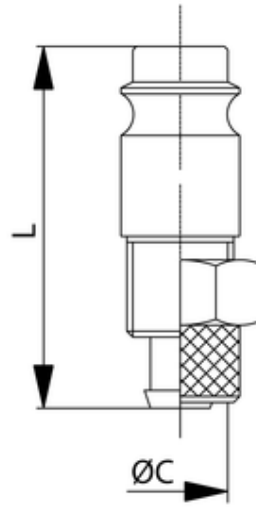

ITV	DN	ØC	L
430063-VN	7,2	4x6	36

Körper:	Messing
Body:	brass
Corpo:	ottone
Betriebstemperatur:	-20 °C bis +100 °C
Working temperature:	-20 °C to +100 °C
Temperatura di esercizio:	da -20 °C a +100 °C
Betriebsdruck:	max. 35 bar
Working pressure:	max. 35 bar
Pressione di esercizio:	max. 35 bar
Medium:	Druckluft, Wasser.
Medium:	compressed air, water.
Fluido:	Aria compressa, acqua.