

# PVC-Gewebes Schlauch

Transparent reinforced PVC tube  
Tubo PVC trasparente rinforzato

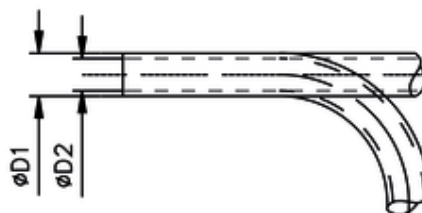

ITV	ØD1	ØD2	bar
636006	12	6	25

Temperatur: -20 °C bis +65 °C  
Temperature: -20 °C up to +65 °C  
Temperatura: da -20 °C a +65 °C