

REG

Regler
Pressure regulator

Regler - Pressure regulator	1/4"	3/8" - 1/2"	3/4" - 1"
Manometeranschluss - Pressure gauge thread	1/8"	1/8"	1/4"
Gewicht - Weight	0,3 kg	0,8 kg	2,2 kg
Befestigung - Wall clamp screw	M4x40	M4x50	M6x75
Regelbereich - Pressure adjusting range	0-12 bar	0-12 bar	0-12 bar
max. Betriebsdruck - max. Inlet pressure	18 bar	18 bar	18 bar
Durchfluss bei 6 bar - Flow rate at 6 bar	850 NI/min	2.600 NI/min	4.600 NI/min
max. Temperatur bei 10 bar - max. Temperature at 10 bar	+50°C	+50°C	+50°C

Einbauposition - Mounting position beliebig - any position
Medium - fluid Luft - air

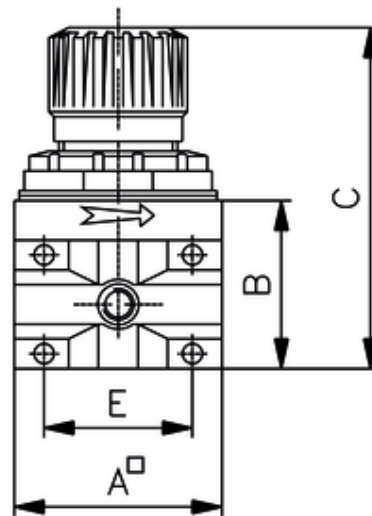

ITV	G	A	B	C	E
901012	G1/4	42	42	85	32